

## DL 320

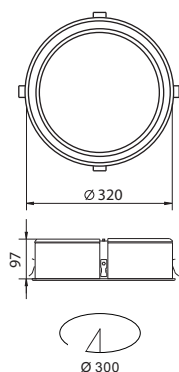

Recessed luminaire for circular T5 lamp. Body is made of steel and aluminium and is available in all RAL colours. Diffuser - opal, the level of diffusor can be regulated.



Index no.	Lamp	Weight	Socket
0000-003569.122E	EVG, 1x22W TL-5C	2,50 kg	2GX13

IP44

230 V  
50 Hz