

DLXS 220 ECO LED

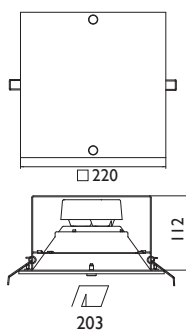

Recessed LED downlights.
 Body is made of steel and aluminium and can be painted in any RAL colour.
 Silver glossy reflector in standard, white painted on request.



- IP44
- decorative front frame made of stainless steel and covered with central mat or clear glass

Index no.	Lumen output	Wattage	Colour temp.	Colour rendering index	Lifetime	Weight
004364.2000/830	2000 lm	26 W	3000 K	Ra > 80	30.000 h	1,20 kg
004364.2000/840	2000 lm	26 W	4000 K	Ra > 80	30.000 h	1,20 kg

IP44 230 V / 50 Hz    