

ELP LED IP65

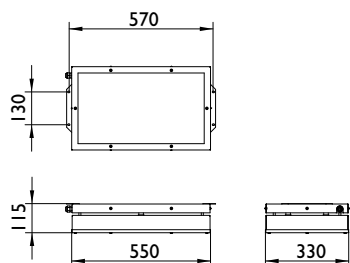

Surface mounted IP65 LED luminaire. Light source - Philips, Osram or Tridonic LED module. Standard EVG ballast, DALI or Touch Dali version on request. Body is made of aluminium profile and available in all RAL colours. High quality, energy efficient white LED light with CRI 80.



Index no.	Lumen output	Wattage	Colour temp.	Colour rendering index	Lifetime	Weight
004086.LL11000/830	11000 lm	75 W	3000 K	Ra > 80	50,000 h	5,00 kg
004086.LL11000/840	11000 lm	75 W	4000 K	Ra > 80	50,000 h	5,00 kg
004086.LL20000/830	20000 lm	145 W	3000 K	Ra > 80	50,000 h	5,00 kg
004086.LL20000/840	20000 lm	145 W	4000 K	Ra > 80	50,000 h	5,00 kg

* Height of the body of 20,000 lm version is 150 mm.

