

PLAFO 650 LED SURF

Instrukcja montażu

Installation instructions

Instructions de montage

Montageanleitung

IP20

230 V
50 Hz

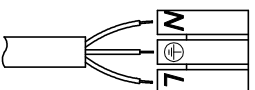
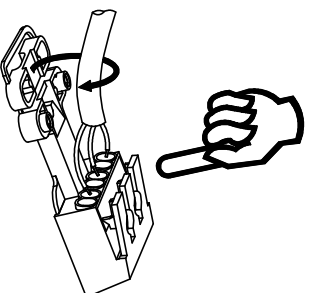
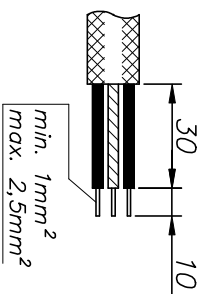
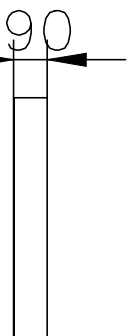
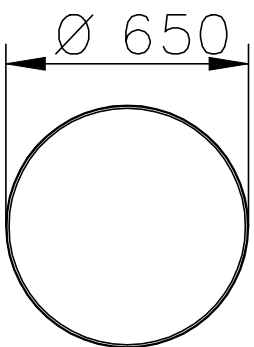
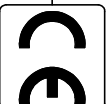
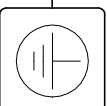

- PL – Wyłączyć zasilanie przed wymianą lampy;
- UK – Disconnect the unit before changing the lamp;
- F – Débrancher l'appareil avant de changer la lampe;
- D – Von den Auswchsein der Lampe die Leuchte von der Netzspannung trennen.

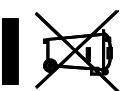

1

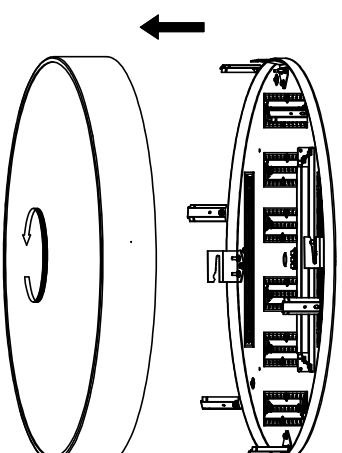

3

